

Side View

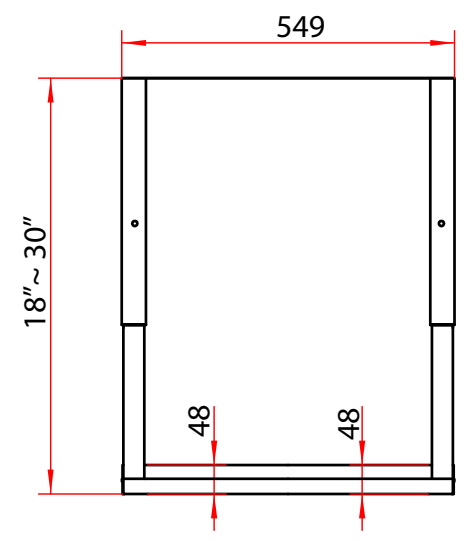

Top View

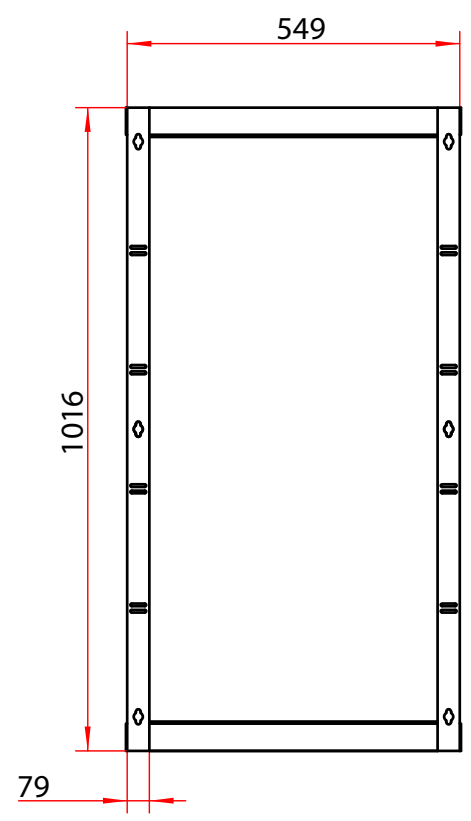

Back View

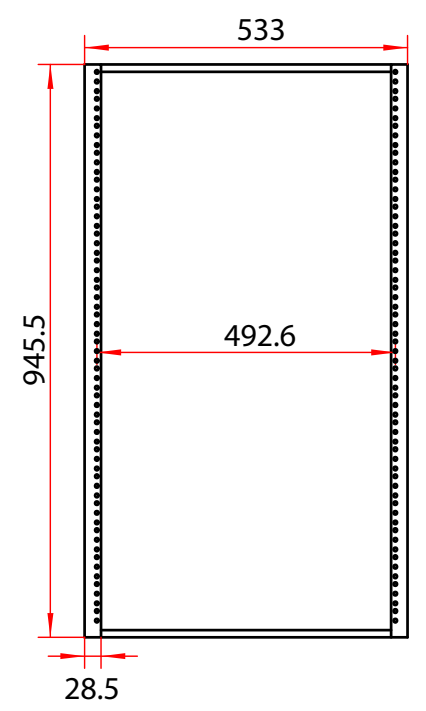

Front View

RoHS

Rack Unit: 20U
 Material: SPCC Cold Rolled Steel
 Thickness: 2mm
 Weight Capacity: 49KG (110lbs)

Part #	SO192018M-3	Part #	Rack Units
Title	20U Swing-Out Wall Mount Rack 21.65* 18-30 * 40 inch Max Loading 50KG, Adjustable Depth	SO192018M-3	20U
Unit	 PI Manufacturing Corp.		
mm			