

**SPECIFICATIONS**

**1.ELECTRICAL:**

- UL APPLICATIONS: 250 VOLTS AC MAX. AT 2 AMPS.
- DIELECTRIC WITHSTANDING VOLTAGE : 1000 VOLTS AC. 60 SEC.
- INSULATION RESISTANCE: 500 MΩ.
- CONTACT RESISTANCE: 20mΩ MAX.
- OPERATING AMBIENT TEMPERATURE: -20°C~ 75°C

**2.MECHANICAL:**

- STRAIN RELIFE: 20POUND MIN.
- DURABILITY: 1200 MATING CYCLES.

**3.MATERIAL:**

- HOUSING: POLYCARBONATE, UL94V-0 OR UL94V-2.
- COLOR: TRANSPARENT OR OTHER COLOR ARE AVAILABLE.
- CONTACT BLADE: COPPER ALLOY.
- GOLD PLATING: 3u"~50u", ARE AVAILABLE.
- SHIELDED SHELL: COPPER ALLOY.

**4. USAGE:**

- SUITABLE FOR STRANDED & SOLID WIRE 23AWG ~ 26 AWG.
- (It can be used for the wire OD from Ø 1.35 ~ Ø1.45)

50u"  
GOLD  
PLATING

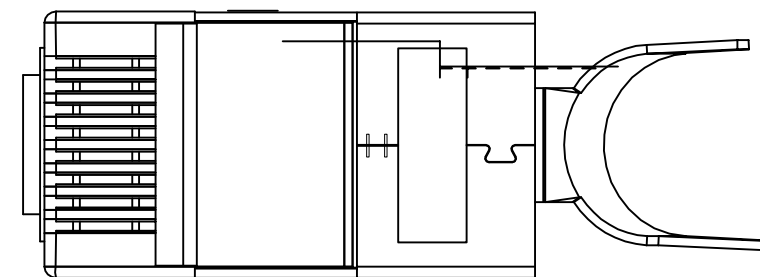
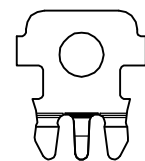

RoHS

Part #	8P8C-C6A-50G3SH	Part #	
Title	RJ45 Cat6a Shielded Modular Plug (2pcs Type) for Stranded / Solid Wire Cable 23-24AWG, Cable Entry OD: 1.5mm - 50pcs/pack		
Unit	 <b>PI Manufacturing Corp.</b>		
mm			

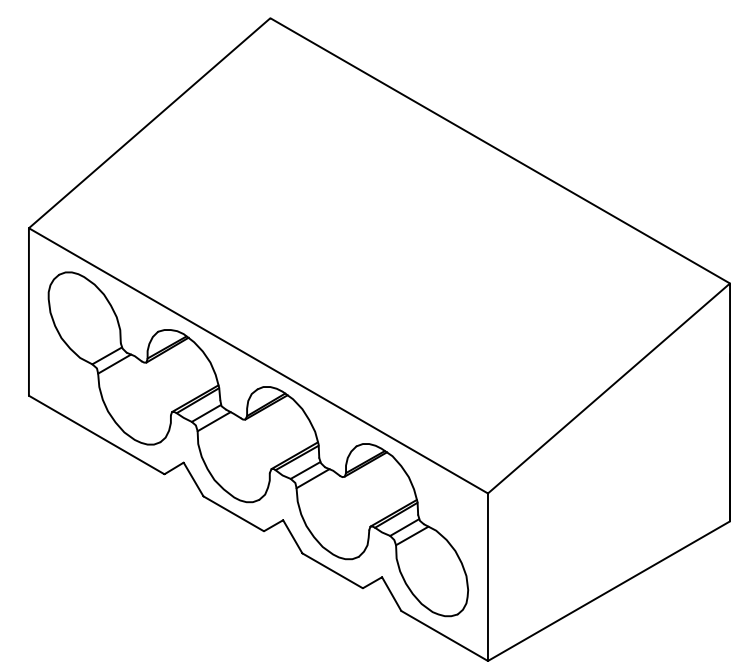
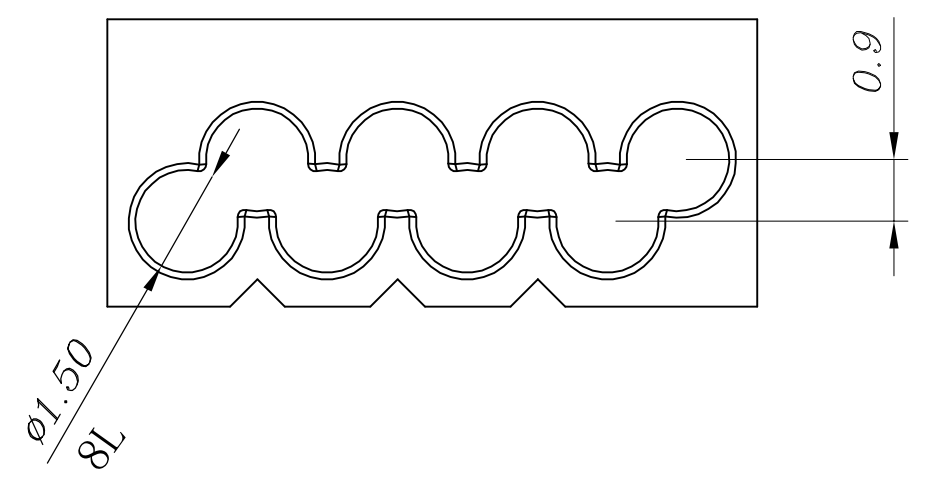
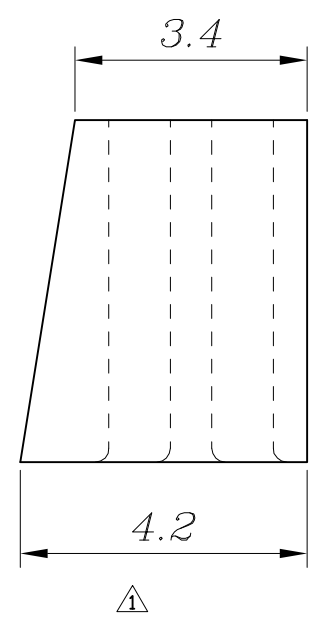
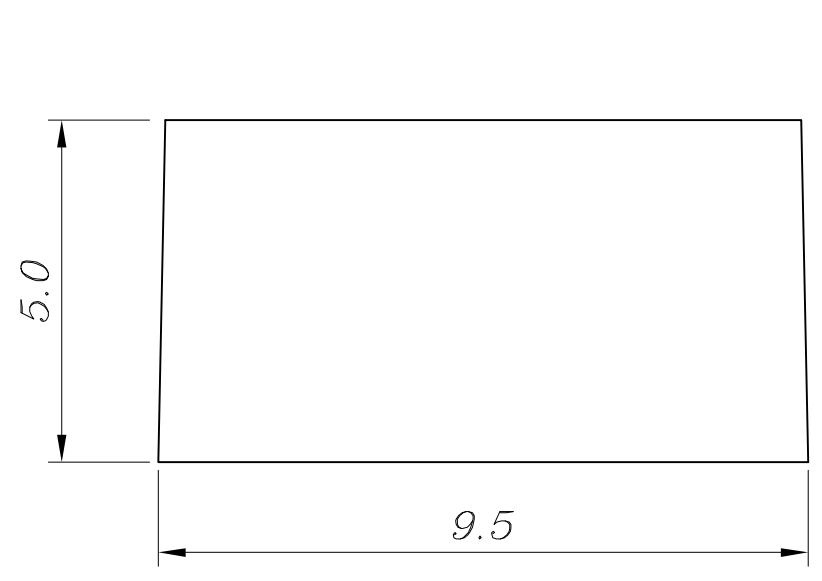

RoHS

Part #	8P8C-C6A-50G3SH	Part #	Cable Length
Title	RJ45 Cat6a Shielded Modular Plug (2pcs Type) for Stranded / Solid Wire Cable 23-24AWG, Cable Entry OD: 1.5mm - 50pcs/pack		
Unit	 <b>PI Manufacturing Corp.</b>		
mm			