

TEMPLATE

PLACE AGAINST HEADER



DRILL 10mm
HOLE FOR CABLE



(1/8")
DRILL 3.2mm HOLE
(2 PLACES)

IF USING TRANSOM 'L' BRACKET DRAW VERTICAL LINE EACH SIDE

FOLD ON DOTTED LINE

PLACE 60MM(2.36") FROM SIDE FRAME

PLACE AGAINST DOOR

PLACE 60MM(2.36") FROM SIDE FRAME

OPPOSITE HINGES FOR
L.H. DOOR INSTALLATION

OPPOSITE HINGES FOR
R.H. DOOR INSTALLATION



6mm (1/4") DIA. ARMATURE GUIDE
PINS HOLE-12.5mm (1/2") DEEP
(2 PLACES)

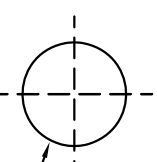

DRILL 9mm (3/8") DIA
HOLE THROUGH DOOR THICKNESS



TEMPLATE INSTRUCTIONS-SLMLINE MAGNET RANGE

This Template is designed for use with the Flat mounting plate for Outward opening doors. It can also be used to mark the position of the Armature plate when using the Transom 'L' bracket.

Fold the Template along the dotted line as indicated.

The edge of the Template must be placed 60mm(2.36") from the side Frame opposite the hinges.

The Door must be closed and latched when using the Template.

Ensure the Template is firmly fixed to the Door and Frame when Marking & Drilling.

Before drilling any holes check that the Frame is deep enough to take the depth of drilling as shown above. Check that the door is between 35 and 55 mm thick.

When all the holes have been drilled remove the Template and fit the Armature Plate and Magnet as per the instructions.